



Water of Leith Flood Prevention Scheme Phase 2

Stakeholder Engagement Meeting

13th May 2014

Agenda

- **Project Update**
 - Previous actions
 - Current key issues
 - Feedback from resident consultations
 - Programme
- **Group Discussion**
- **Way Forward**

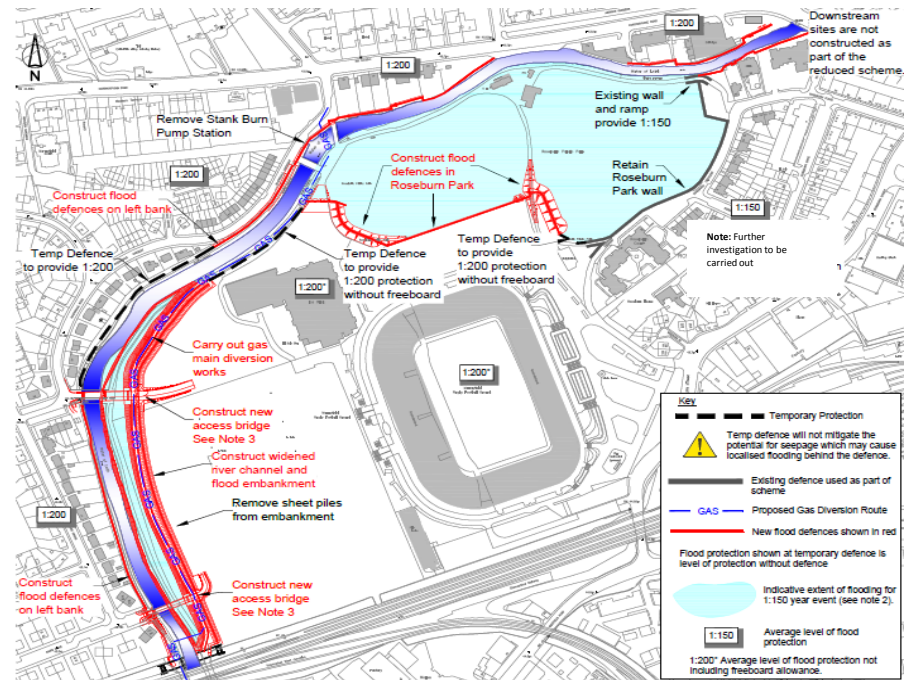

Previous Actions

No	Action	Status
1	Explore Options for playground relocation	On-Going
2	Finalise proposals for design adjacent to playground	Complete
3	Safe routes through park	On-Going
4	Stakeholder Constraints	On-Going

Key Issues

Issue	Description
Pansy Walk	<ul style="list-style-type: none">• Flood Gate to be reinstated
Construction Impact	<ul style="list-style-type: none">• Good level of engagement in the period with those directly affected by the Works
Options Analysis	<ul style="list-style-type: none">• Report being compiled but no decisions yet taken
Funding	<ul style="list-style-type: none">• Funding application from SG turned down. Outcome of options analysis will dictate funding requirement
Planning	<ul style="list-style-type: none">• Outcome of options analysis will dictate planning application requirements

Proposals Update

Action	Current Proposal
Omit Stank Burn Pump Station	<ul style="list-style-type: none"> Omit from the Scheme
Temporary Defences at Ice Rink & Riversdale	<ul style="list-style-type: none"> <u>Analysis not yet complete</u>
Retain Existing Roseburn Park Wall	<ul style="list-style-type: none"> Utilise existing wall Height of wall at north east corner will be raised and parts of wall strengthened New wall to be constructed between bund and existing wall based on playground relocating
Omit sheet piles from under embankments	<ul style="list-style-type: none"> Proceed with proposal – <u>Awaiting SRU feedback</u>
Wall behind Baird Grove	<ul style="list-style-type: none"> Move wall closer to property boundary
Gravity wall from Pansy Walk	<ul style="list-style-type: none"> Change to sheet pile wall to minimise impact on property
Stockbridge to A8	<ul style="list-style-type: none"> Proceed with do minimum proposal

Emerging Scheme

NO FINAL DECISION MADE

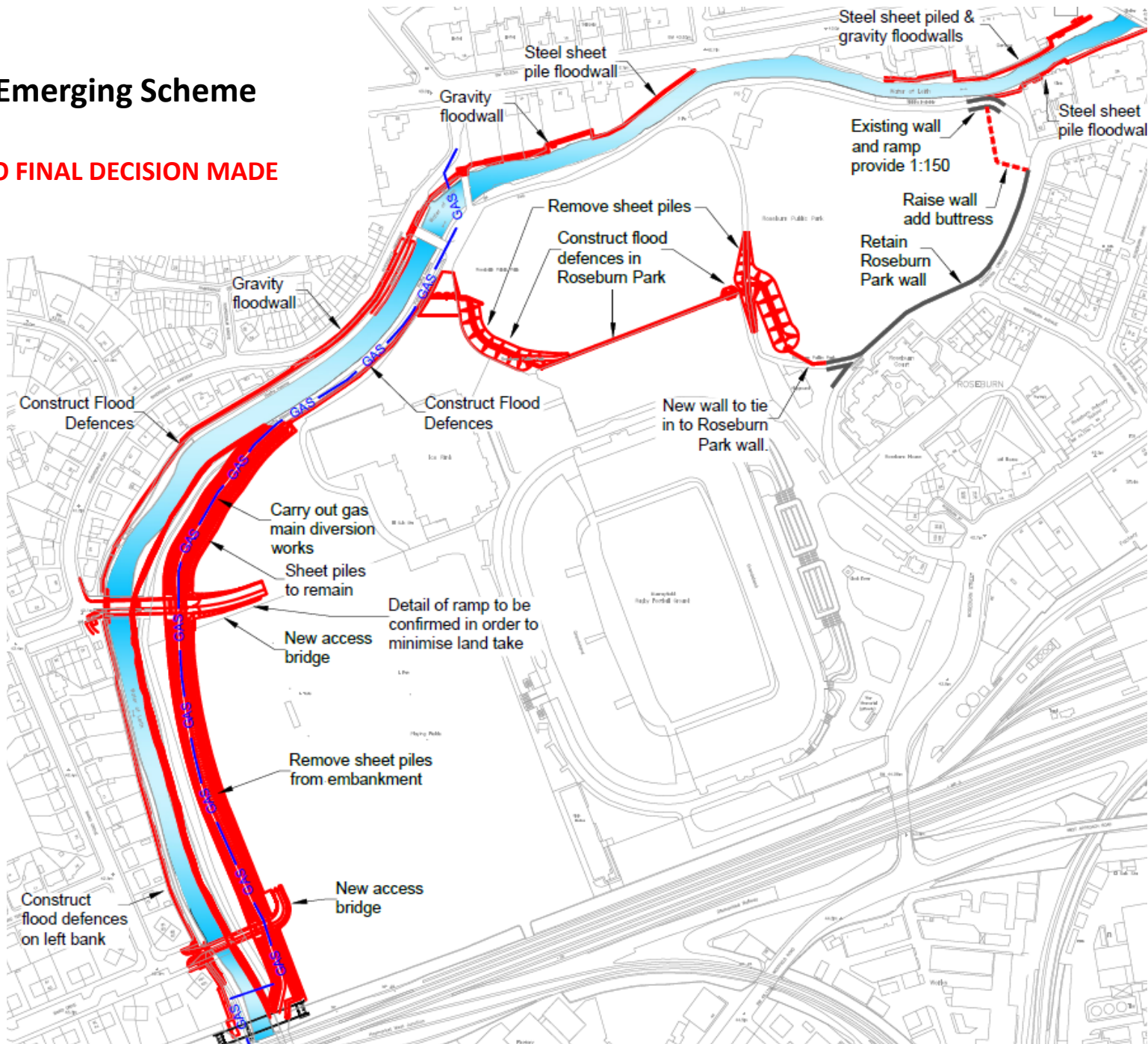

Target Dates

Spring 2014

Project Definition

Public Consultation Meeting

Summer 2014

Planning Application

Publish OJEU

Funding Decision

End 2014

Planning Permission

Prequalification complete



Note: All timescales are indicative and will depend on a range of factors including no delays through planning



Thank You

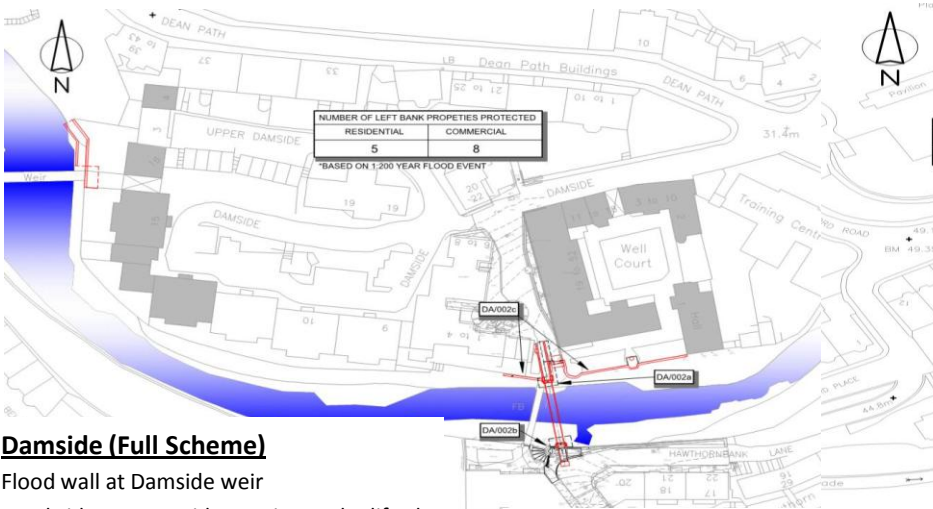

Damside (Full Scheme)

Flood wall at Damside weir
Footbridge at Damside requires to be lifted
Flood wall in area around Well Court

Mitigation

Provide flood-guard to property thresholds at Well Court

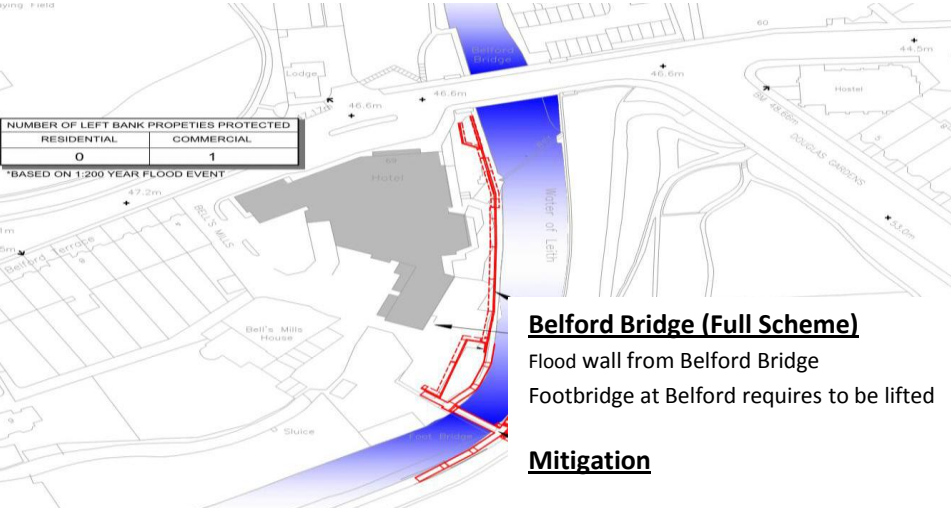

Belford Bridge (Full Scheme)

Flood wall from Belford Bridge
Footbridge at Belford requires to be lifted

Mitigation

Provide flood-guard to the plant room of the hotel

For Information

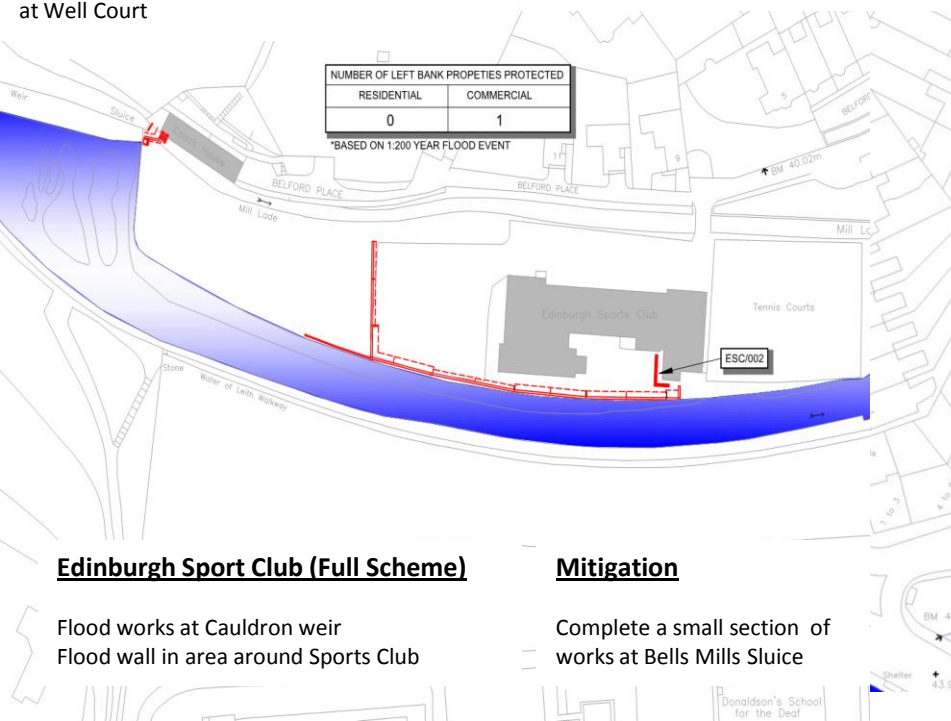

Edinburgh Sport Club (Full Scheme)

Flood works at Cauldron weir
Flood wall in area around Sports Club

Mitigation

Complete a small section of works at Bells Mills Sluice

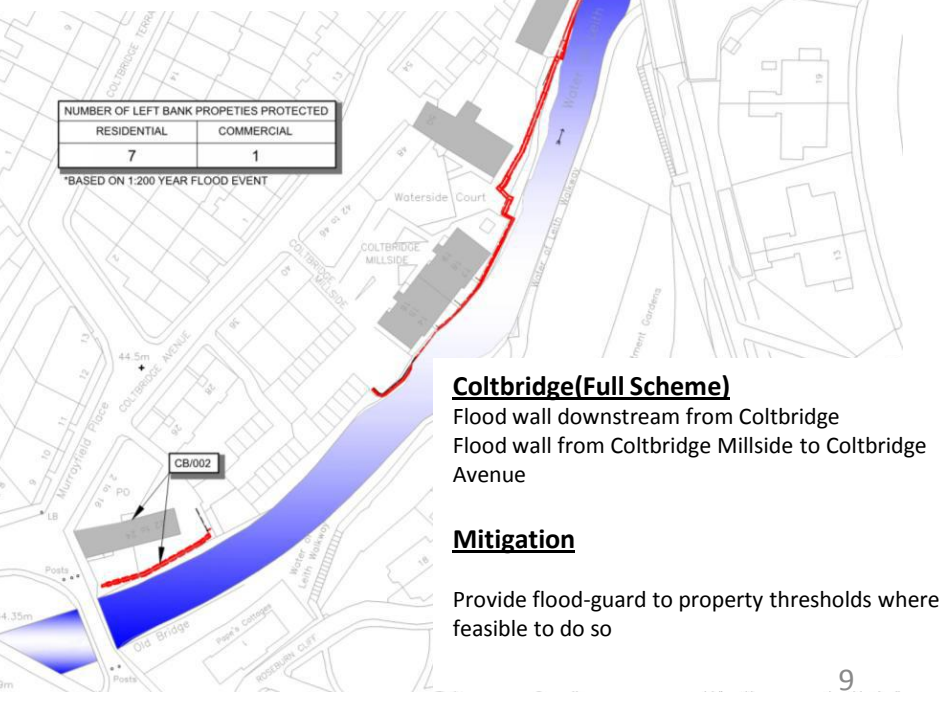

Coltbridge(Full Scheme)

Flood wall downstream from Coltbridge
Flood wall from Coltbridge Millside to Coltbridge Avenue

Mitigation

Provide flood-guard to property thresholds where feasible to do so