

Trees							
Key	Species	Form	Girth (cm)	Height (cm)	Clear stem (cm)	Root	Number
Ag	Common Alder (<i>Alnus glutinosa</i>)	EHS	16-18	450-500	200	rootball	3
Sf	Crack Willow (<i>Salix fragilis</i>)	EHS	16-18	450-500	200	rootball	8

Flood Berm Woodland Mix							
To be planted at 1.5m centres in groups of 3-9 wherever possible.							
%	Species	Form	Height (mm)	Age	Root	Container	WM3 (491m ²) Number
15	Silver Birch (<i>Betula pendula</i>)	transplant	600-900	1+1	bareroot	-	32
18	Hazel (<i>Corylus avellana</i>)	transplant	400-600	1u1	bareroot	-	38
5	Holly (<i>Ilex aquifolium</i>)	-	300-400	-	container grown	2 litre	11
2	Common Wild Crab (<i>Malus sylvestris</i>)	transplant	600-900	1+1	bareroot	-	5
10	Bird Cherry (<i>Prunus padus</i>)	transplant	600-900	1+1	bareroot	-	22
12.5	Blackthorn (<i>Prunus spinosa</i>)	transplant	400-600	1+1	bareroot	-	27
12.5	Dog Rose (<i>Rosa canina</i>)	transplant	600-900	1+1	bareroot	-	27
15	Rowan (<i>Sorbus aucuparia</i>)	transplant	600-900	1+1	bareroot	-	32
10	Guelder rose (<i>Viburnum opulus</i>)	transplant	400-600	1+1	bareroot	-	22

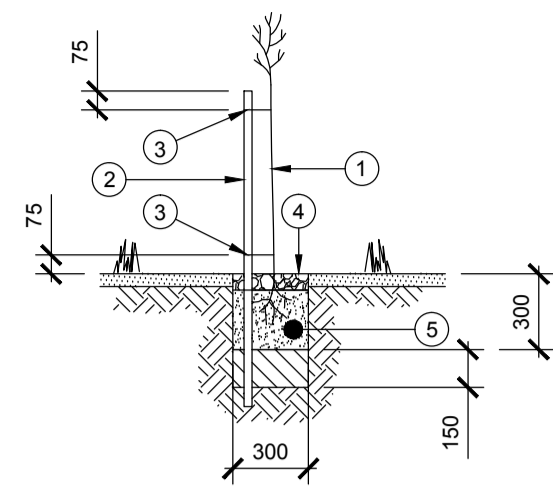

Tree or Shrub Transplant Planting
Not to scale

- Notes**
1. Tree or Shrub Transplant: 60-80cm and 80-100cm height, bare root and in accordance with the National Plant Specification, BS 3936 and BS 4043.
 2. Stakes to be pressure treated Softwood or Chestnut 32mm dia. Stakes must be at least 75mm above top of tie.
 3. 2 No. biodegradable ties positioned 75mm from top of stake and 75mm above ground level.
 4. Organic Bark Mulch in soft landscape areas to be spread evenly over a 1m diameter circle around the tree, to a depth of 75mm after settlement. Sample to be approved.
 5. Planting pits to be minimum of 300 x 300 x 300mm. Cultivate base of pit to 150mm to ensure free drainage. Backfill with 80:20 topsoil: peat free compost mix.

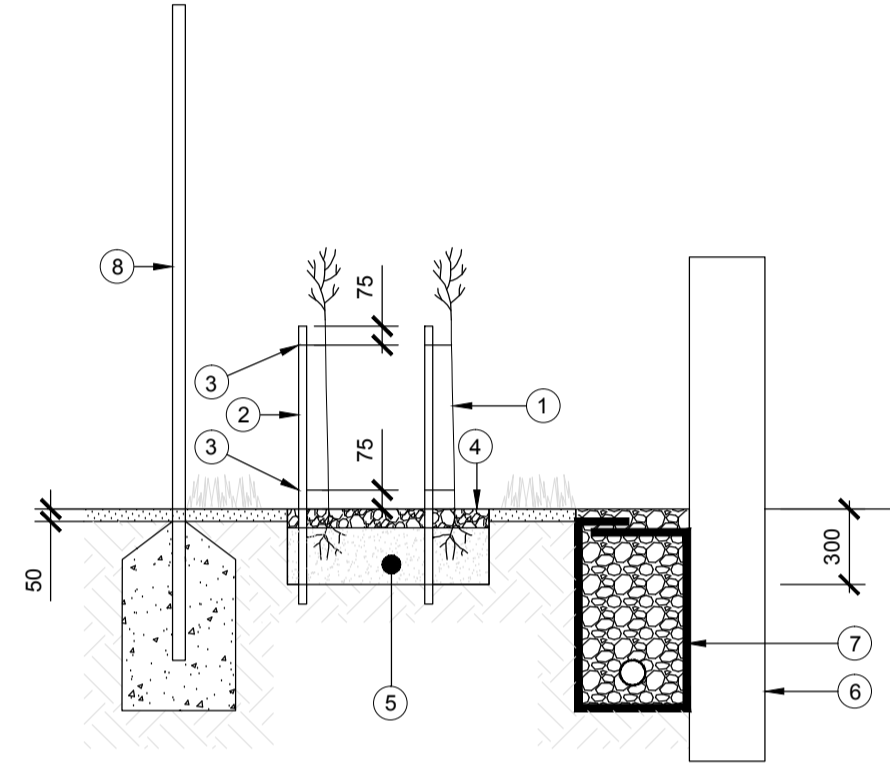

Security Planting
Not to scale

- Notes**
1. Tree or Shrub Transplant/Whip: 40-60cm height, bare root and in accordance with the National Plant Specification.
 2. Stakes to be pressure treated Softwood or Chestnut 32x32mm dia. Stakes must be at least 75mm above top of tie.
 3. 2 No. biodegradable ties positioned 75mm from top of stake and 75mm above ground level.
 4. 75mm deep Organic Bark Mulch in soft landscape areas. Sample to be approved.
 5. Planting pits to be minimum of 300 x 300 x 300mm. Remove compaction to 300mm depth and cultivate base of pit to ensure free drainage. Backfill with arisings (sample to be approved)
 6. Indicative flood wall and filter drain to be designed by contractor.
 7. Terram Rootguard or other approved geotextile to be used where planting closer than 5m filter drain.
 8. Proposed 2m high fence to be designed by contractor.

For Continuation Refer to WoL-MF-LP-003

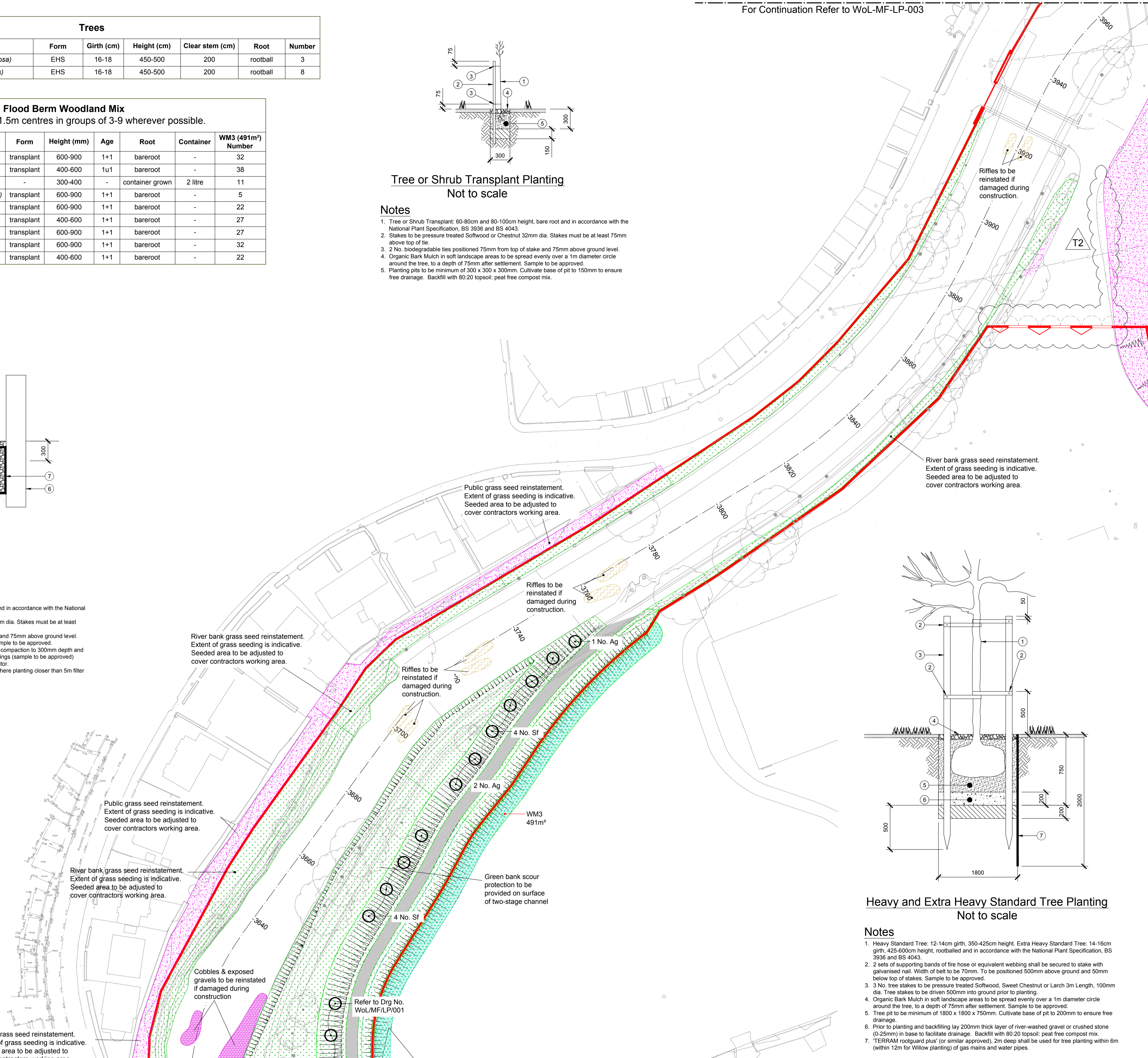

- Notes**
1. Do not scale this drawing.
- KEY FOR LANDSCAPE WORKS**
- High level other ledges to be provided.
 - Cobbles & exposed gravels to be reinstated if damaged during construction.
 - Riffles to be reinstated if damaged during construction.
 - Pools to be reinstated if damaged during construction.
 - Proposed EHS tree planting
 - Proposed HS tree planting
 - Proposed feathered tree planting
 - Proposed tree and shrub mix
 - Proposed security planting.
 - Proposed grass seed for public space/garden reinstatement.
 - Proposed sports field grass mix Refer to PSD Specification Appendix Z
 - Reinstated riverbanks, channel and flood embankment slopes. To be seeded with riverbank reinstatement mix.
 - Bramble planting
 - Hedge planting

General notes:
Wherever possible, trees to be coppiced or pollarded to facilitate construction of the flood works.
All river banks to be fully repaired or reinstated following construction activities.
Notable species of flora and fauna will be protected or translocated if required prior to construction works starting.
Japanese Knotweed, Giant Hogweed and Himalayan Balsam within the contract areas to be treated with translocated herbicide.
Areas of scrub and willow to be retained where possible.
Extent of grass seeding is indicative. Seeded area to be adjusted to cover contractors working area.
Suitably qualified arboricultural specialist to advise on tree removal or retention.

Site specific notes:
Japanese Knotweed and Himalayan Balsam present on site.
Mature trees along the riverside and overhanging roots should be protected as much as possible.
Riffles and cobbles to be reinstated if damaged during construction.
20No. woodcrete Bat boxes and 20No. woodcrete Bird boxes to be installed on existing mature trees as well as under bridges in accordance with the Ecological Survey Report contained in Volume 4 and to be agreed with Ecological Clerk of Works.

T2	15/04/15	DB	CE	GB
Revised as clouded				
T1	20/03/15	DB	CE	GB
Tender Issue				
Issue	Date	By	Chkd	Appd

ARUP
5th Floor, 225 Bath Street, Glasgow, G2 4GZ.
Tel: +44 (0)141 332 8534 Fax: +44 (0)141 332 3739
www.arup.com

Client
EDINBURGH
THE CITY OF EDINBURGH COUNCIL
FLOODPROTECTION

Job Title
**Water of Leith
Flood Prevention
Phase 2**

**Landscape Proposals
Sheet 2**

Scale at A1 1:500

Discipline	Infrastructure
Job No	Drawing Status
216835-85	TENDER
Drawing No	Issue
WoL-MF-LP-002	T2

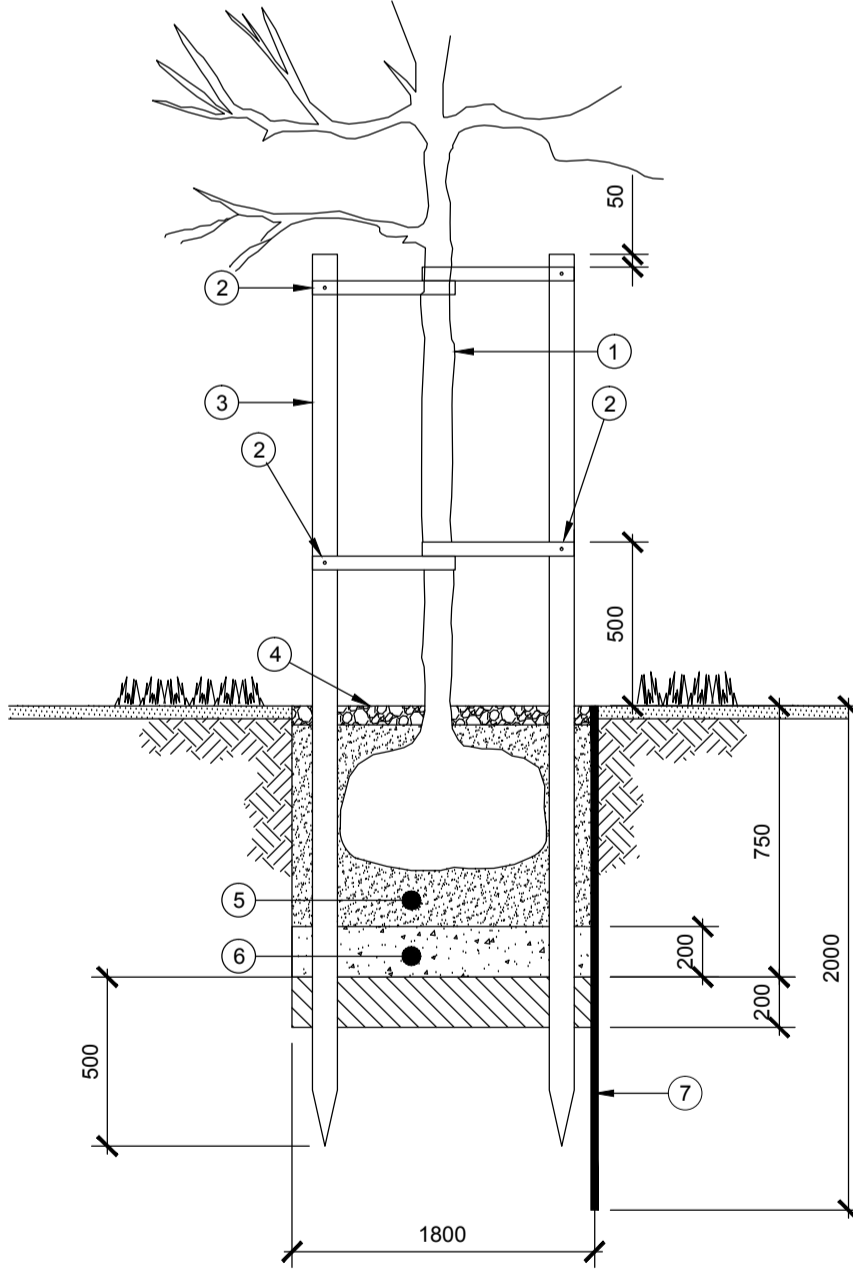

Heavy and Extra Heavy Standard Tree Planting
Not to scale

- Notes**
1. Heavy Standard Tree: 12-14cm girth, 350-425cm height. Extra Heavy Standard Tree: 14-16cm girth, 425-600cm height, rootballed and in accordance with the National Plant Specification, BS 3936 and BS 4043.
 2. 2 sets of supporting bands of fire hose or equivalent webbing shall be secured to stake with galvanised nail. Width of belt to be 70mm. To be positioned 500mm above ground and 50mm below top of stakes. Sample to be approved.
 3. No. tree stakes to be pressure treated Softwood, Sweet Chestnut or Larch 3m Length, 100mm dia. Tree stakes to be driven 500mm into ground prior to planting.
 4. Organic Bark Mulch in soft landscape areas to be spread evenly over a 1m diameter circle around the tree, to a depth of 75mm after settlement. Sample to be approved.
 5. Tree pit to be minimum of 1800 x 1800 x 750mm. Cultivate base of pit to 200mm to ensure free drainage.
 6. Prior to planting and backfilling lay 200mm thick layer of river-washed gravel or crushed stone (0-25mm) in base to facilitate drainage. Backfill with 80:20 topsoil: peat free compost mix.
 7. TERRAM rootguard plus (or similar approved), 2m deep shall be used for tree planting within 6m (within 12m for Willow planting) of gas mains and water pipes.