

# Water of Leith Flood Prevention Scheme Phase 2

Stakeholder Engagement Group Update  
15 September 2015

◆ EDINBURGH ◆  
YOUR COUNCIL – YOUR ENVIRONMENT

# Contents

- Actions from Previous Meeting
- Project Progress and Timescales
- Advanced Utility Works

# Actions from Previous Meeting

Previous Action	Comment
Finalised drawings to be sent to Stakeholder Engagement Group and all groups involved in the Pansy Walk details	Drawing WoL-MF-SA-001 T1 shows the footpath closures the details of which have to be agreed with CEC through the TTRO process. The section of footpath from the Baird Drive bridge to the Ice Rink Pedestrian bridge on the right bank of the WoL will not be available for pedestrians and passage over this section will be via the public footpaths along Baird Drive, Riversdale Road and Riversdale Crescent. Footpath access through Roseburn Park will be maintained.
JWN to meet with school to discuss working hours and construction traffic	The schools have been apprised of the information shown on drawing WoL-MF-SA-001 T1, in particular of roads where no construction access will be allowed. Site working hours are between 07.00 and 19.00 on weekdays and 08.00 to 13.00 on Saturdays
Construction Traffic Plan to be sent out to Stakeholder Engagement Group	Drawing WoL-MF-SA-001 T1 attached to this update
Another discussion with Scottish Water to be held in regards to the removal of the pumping station at the north east of the park	Scottish Water are not involved in the provision of the pumping station and CEC will become the asset owner. The intent is to review the requirements for the pumping station with the selected Contractor
A briefing note on the pumping station and the area that is required to be used to be sent to Stakeholder Engagement Group	A presentation was given to the Corstorphine Community Council on 23 June 2015 of the area required along with the proposed rehabilitation measures.
JWN to discuss directly with DAFS Cricket Club and the Primary School in regards to the cricket pitch and football practice field	Discussions have been held. Refer to Drawing WoL-MF-SA-001 T1 attached which shows the lands available for the mentioned facilities
Residents to be contacted with an update once tender has been realised	Public Information Open Day held on 19 August 2015
Copy of the Contract which states Ice Rink requirements to be sent to Murrayfield Ice Rink Ltd for information	Details sent and it is understood that the Ice Rink are satisfied with the proposals.

# Project Progress & Timescales

Activity	Date	Comment
Main works tenders received from three bidders	2 July 2015	Tender evaluation being finalised
Approval to commence physical works	4 August 2015	Completed
Ecological surveys for gas main works	5 August 2015	Completed
Public Information Day	19 August 2015	Open day held
Commence gas main diversion	14 September 2015	Gas main diversion commenced
Commence Riversdale Crescent service diversions	October 2015	Programme being finalised
Contract Award	November 2015	On programme

# Advanced Utility Works

- Diversion of gas main by SGN
- Service diversions on Riversdale Crescent by
  - Scottish Power
  - CEC Streetlighting

# Gas Main Diversion

Existing gas main

**Residual Risk**  
Existing medium pressure gas main will be live during diversion operations. Contractor to agree any proposed works above the existing gas main with SIGN.

Line of gas main to be diverted

## Programme for diversion

- commenced works at tie in points; 14 September 2015
- completion date; programme under review, latest March 2016

# Riversdale Crescent Diversions

Programme for diversions  
- works to be carried out within period  
October to December 2015  
- programme for actual physical works  
under discussion

New location of  
services

Existing location of  
services

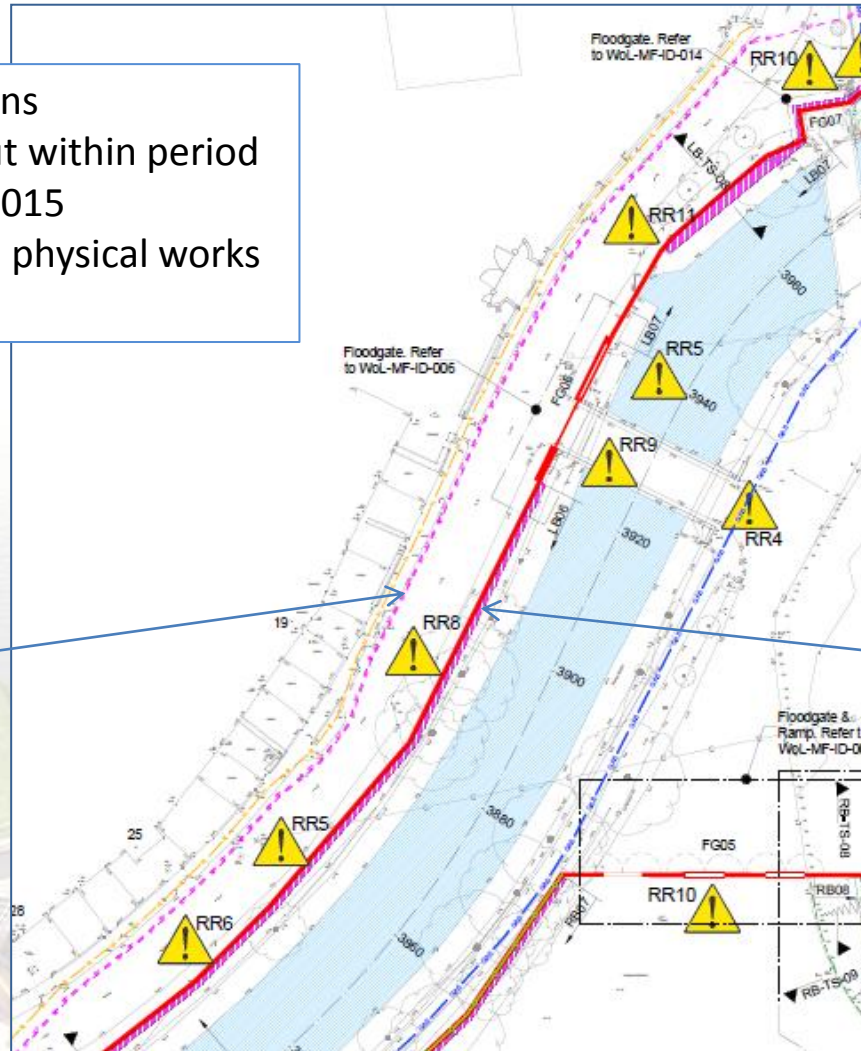



Thank You